

**Catalogue No.: 1105 L****Product index: W150****LED multifunctional rear lamp\**

diode  
voltage  
left



<b>Catalogue No.</b>	<b>1105 L</b>
Product index	W150
assembly side	left
voltage	12V-24V
wires	200cm YLY-S 6x0,5mm <sup>2</sup>
diode	yes
bulbs	no
multifunction lamp	●
single function lamp	
front position light	
side position light	
rear position light	●
front clearance light	
rear clearance light	
daylight driving light	
reversing lights	●
fog light	●
working lights	
road light	
brake lights	●
front direction indicator	
side direction indicator	
rear direction indicator	●
license plate light on side	
license plate light on bottom	●
reflecting device	●
Jaeger connector	
WAŚ connector 7-pin	
WAŚ connector 5-pin	
Jaeger connector opcja	
with bulb/-s opcja	
TYCO connector opcja	
Schlemmer connector opcja	
WAŚ connector 7-pin opcja	
WAŚ connector 5-pin opcja	
IP Code	IP66/IP68
light beam @ 25°C	

**Product description:**

W150 is a modern LED rear lamp with the unique shape of a position light, which makes both lamp recognisable and highly visible on the road. The LED position lamp modules are made of a special compound thanks to which the particular lightning points are not visible and it is only possible to see the shape and is pleasant to the eye glow with a neon-like effect. The lamp can be used in working voltage 12V and 24V. It is EC, EMC approved and it is also rated for IP 66/68. These are probably the best-looking lamps available on the market.

Power consumption at operating voltage 12V:

- position light: 1,4W
- stop light: 1,4W
- direction indicator light: 2,2W
- reversing light: 2,2W
- fog light: 1,3W
- numberplate light: 0,7W

Power consumption at operating voltage 24V:

- position light: 2,9W
- stop light: 2,9W
- direction indicator light: 4,3W
- reversing light: 4,3W
- fog light: 1,3W
- numberplate light: 1,4W

Weight: 0,62kgW

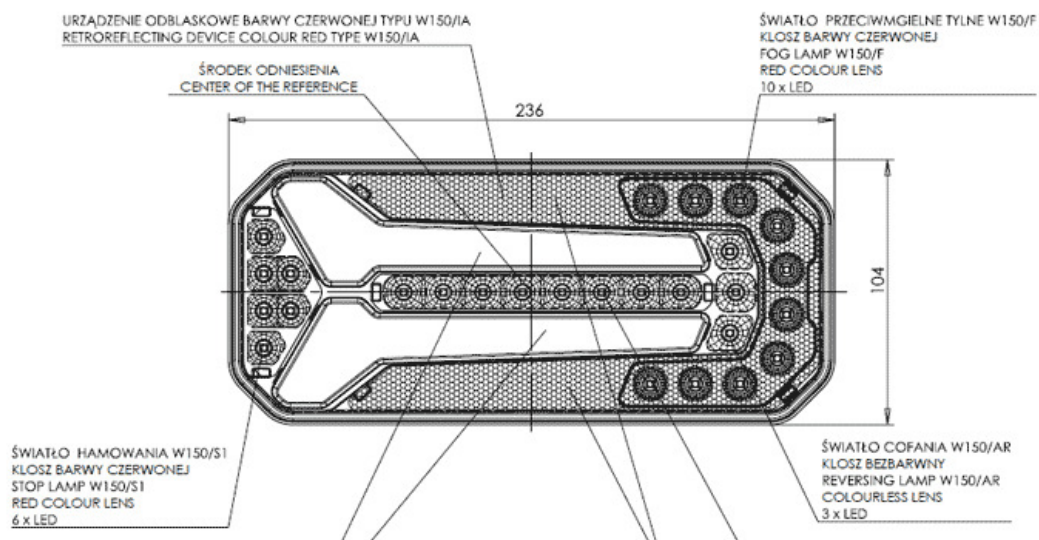

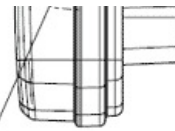
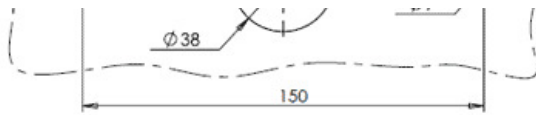

OŚWIETLENIE TYLNEJ TABLICY REJESTRACYJNEJ TYPU W150/L  
 KŁOSZ BEZBARWNY  
 REAR REGISTRATION PLATE DEVICE TYPE W150/L  
 COLOURLESS LENS  
 2 x LED

Wersja 1  
Version 1

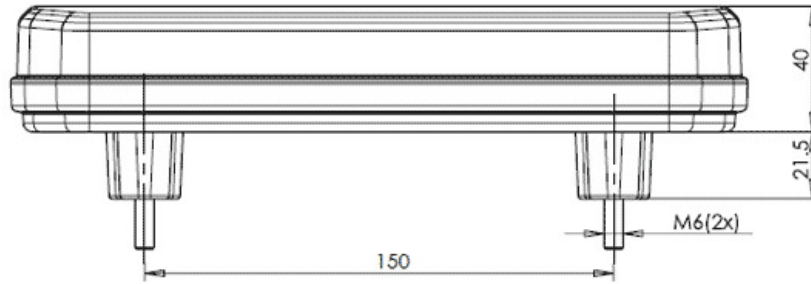

Wersja 2  
Version 2

